

## Zubehör / Accessories:

Artikel-Nr.	Bezeichnung	Designation	Lfd.	Stück
# 22 4300	Rumpf	<i>Fuselage</i>	3	1
# 22 4301	Akkudeckel	<i>Battery hatch cover</i>	4	1
# 22 4302	Motorhaube	<i>Cowl</i>	5	1
# 22 4303	Hauptfahrwerk	<i>Main undercarriage</i>	6	1
	Hauptfahrwerk Schrauben 3x20mm	<i>Main landing gear Screw 3x20mm</i>		1 4
# 22 4304	Spornfahrwerk	<i>Tailwheel</i>		
	Spornfahrwerk Schrauben 3x22mm Federn für Spornradlenkung Ø 5mm	<i>Tailwheel Screw 3x22mm Tension springs for steerable tailwheel Ø 5mm</i>	24	1 2 2
# 22 4305	Höhenleitwerk	<i>Tailplane</i>	7	1
# 22 4306	Seitenleitwerk	<i>Fin</i>		1
	Seitenruder-Dämpfungsfläche Seitenruder	<i>Fin Rudder</i>	8 9	1 1
# 22 4307	Tragflächen links, rechts	<i>Wing panel L.H./R.H.</i>	10, 11	1
# 22 4308	Steckungsrohr Ø 8mm	<i>Wing joiner tube Ø 8mm</i>	12	1
# 22 4313	Kleinteilesatz	<i>Small parts kit</i>		
	(# 68 3112) 5 St. (# 68 3112) 5 St. Klettband Pilzkopf 25x60mm Klettband Velours 25x60mm Schraube f. Hauptfahrwerk 3x20mm Schraube f. Höhenleitwerk M4x42mm Schraube f. Seitenleitwerk 2,6x12mm Ruderhorn Schraube 1,7x20mm	<i>Velcro tape, hook 25x60mm Velcro tape, loop 25x60mm Main undercarriage retaining screws 3x20mm Screw for elevator M4x42mm Fin retaining screws 2,6x12mm Control surface horn Screw 1,7x20mm</i>	27 28 20 21 23 4 12	2 2 4 2 2 4 12
# 70 3455	Gestängeanschluss	<i>Pushrod connector</i>		
	Gestängeanschluss Ø 6mm U-Scheibe M2 Mutter M2 Inbus-Gewindestift M3x3mm	<i>Swivel pushrod connector Ø 6mm Washer M2 Nut M2 Allen-head grubscREW M3x3mm</i>		2 2 2 2
# 22 4312	Tragflächenschrauben M4x80mm	<i>Wing screws M4x80mm</i>	26	2

Artikel-Nr.	Bezeichnung	Designation	Lfd.	Stück
# 22 4309	Dreiblatt-Luftschraube 12x8"	<i>Three-bladed propeller 12x8"</i>	13	1
# 22 4310	Spinner Ø 52mm	<i>Spinner</i>		
	Spinnerrückplatte Ø 52mm Spinnerkappe Ø 52mm Spinner-Zentralschraube M3x45mm	<i>Spinner backplate Ø 52mm Spinner cap Ø 52mm Spinner screw M3x45mm</i>	14 15 25	1 1 1
# 22 4311	Luftschraubenmitnehmer Ø 5mm/8mm	<i>Prop adapter Ø 5mm/8mm</i>		
	Spannzange Ø 5mm Spannhülse U-Scheibe M8 Mutter M8	<i>Taper collet Ø 5mm Clamping bush Washer M8 Nut M8</i>	16 17 18 19	1 1 1 1
# 33 3125	Motor PERMAX BL-O 3720-630	<i>Motor PERMAX BL-O 3720-630</i>		1
# 7 2235	Regler MULTIcont BL-50	<i>Controller MULTIcont BL-50</i>		1
# 6 5114 x4	Servo MS-13020	<i>Servo MS-13020</i>		1
# 15 7362	Akku Li-BATT FX 4/1-2600 (M6)	<i>Battery Li-BATT FX 4/1-2600 (M6)</i>		1
# 8 5403	Strom-Sensor 35A (M6) für M-LINK Empfänger	<i>Current sensor 35 A (M6) for receivers M-LINK</i>		1
# 7 3020	MULTIlight, 5 LEDs	<i>MULTIlight, 5 LEDs</i>		1
# 9 2516	Ladekabel (M6) für # 9 2545	<i>Charge lead (M6) for # 9 2545</i>		1
# 8 5019 x2	Verlängerungskabel 15cm	<i>Extension lead 15cm</i>		1
# 5 5808	Empfänger RX-5 light M-LINK	<i>Receiver RX-5 light M-LINK</i>		1
# 5 5818	Empfänger RX-7 M-LINK	<i>Receiver RX-7 M-LINK</i>		1



### # 22 4300 Rumpf/ Fuselage/ Fuselage

3

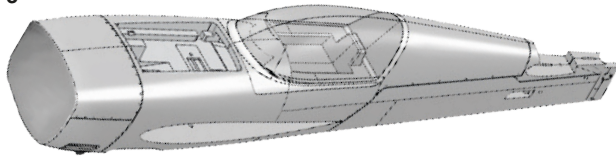

### # 22 4305 Höhenleitwerk/ Tailplane/ Profondeur

7

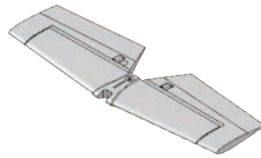

### # 22 4312 Tragflächenschrauben/ Wing screws/ Vis de fixation de l'aile

26  
x2  M4x80mm

### # 22 4313 Kleinteilesatz/ Small parts kit/ Kit de petit nécessaire

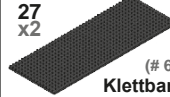

(# 68 3112) 5 St.  
**Klettband Pilzkopf 25x60mm**  
Velcro tape, hook  
Bande Velcro côté crochets

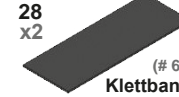

(# 68 3112) 5 St.  
**Klettband Velours 25x60mm**  
Velcro tape, loop  
Bande Velcro côté velours

20  
x4  **Schraube f. Hauptfahrwerk 3x20mm**  
Main undercarriage retaining screw  
Vis pour train principal

x4  **Ruderhorn**  
Control surface horn  
Guignol

21  
x2  **Schraube f. Höhenleitwerk M4x42mm**  
Screw for elevator  
Vis cruciforme à tête fraisée pour profondeur

x12  **Schraube 1,7x20mm**  
Screw  
Vis

23  
x2  **Schraube f. Seitenleitwerk 2,6x12mm**  
Fin retaining screw  
Vis de fixation pour la dérive

### # 22 4301 Akkudeckel/ Battery hatch cover/ Couvercle de compartiment d'accu

4



### # 22 4310 Spinner/ Spinner/ Cône

14  **Spinnerrückplatte Ø 52mm**  
Spinner backplate  
Plateau arrière de cône

15  **Spinnerkappe Ø 52mm**  
Spinner cap  
Cône

25  **Spinner-Zentralschraube**  
Spinner central screw  
Vis centrale pour le cône

### # 22 4309 Dreiblatt-Luftschaube/ Three-bladed propeller/ Hélice



### # 22 4302 Motorhaube/ Cowl/ Capot

5



### # 22 4303 Hauptfahrwerk/ Main undercarriage/ Train d'atterrissage principal

6

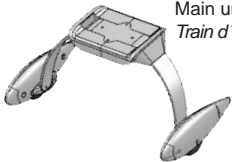

**Hauptfahrwerk**  
Main undercarriage  
Train d'atterrissage principal

x4  **Schraube 3x20mm**  
Screw  
Vis

### # 22 4307 Tragflächen links, rechts/ Wings L.H./R.H/ Ailes gauche, droite

10, 11  
x2

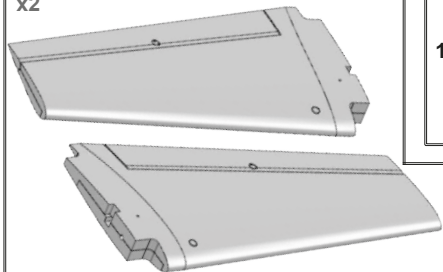

### # 22 4311 Luftschaubenmitnehmer/ Prop adapter/ Plateau hélice

16  **Spannzange Ø 5mm**  
Taper collet  
Kit de serrage

19  **Mutter M8**  
Nut  
Ecrou

17  **Spannhülse**  
Clamping bush  
Douille de serrage

18  **U-Scheibe M8**  
Washer  
Rondelle

### # 22 4304 Spornfahrwerk/ Tailwheel/ Roulette de queue



**Spornfahrwerk**  
Tailwheel  
Roulette de queue

x2  **Schraube 3x22mm**  
Screw  
Vis

24  **Federn für Spornradlenkung Ø 5mm**  
Tension springs for steerable tailwheel  
Ressort de commande pour roulette de queue

### # 22 4308 Steckungsrohr/ Wing joiner tube/ Longeron

12  Ø 8mm

### # 22 4306 Seitenleitwerk/ Fin/ Dérive

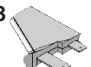
8  **Seitenruder-Dämpfungsfläche**  
Fin  
Stabilisateur de direction

9  **Seitenruder**  
Rudder  
Gouverne de direction

### # 70 3455 Gestängeanschluss/ Pushrod connector/ Raccord de tringles

x2  **Inbus-Gewindestift M3x3mm**  
Allen-head grub screw  
Vis six pans creux

x2  **U-Scheibe M2**  
Washer  
Rondelle

x2  **Gestängeanschluss Ø 6mm**  
Swivel pushrod connector  
Pièce de fixation de tringle

x2  **Mutter M2**  
Nut  
Ecrou

### # 33 3125 Motor PERMAX BL-O 3720-630 Motor Moteur



### # 15 7362 Akku Li-BATT FX 4/1-2600 (M6) Battery Accu



### # 7 2235 Regler MULTiCont BL-50 Controller Variateur

