

I

Sender öffnen
open transmitter
ouvrir l'émetteur
aprire trasmettitor
abrir transmisor

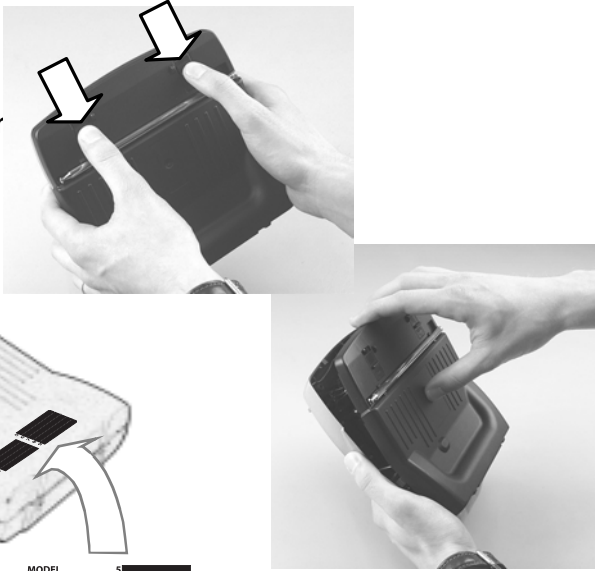

Antennenfach
aerial compartment
Compartment pour l'antenne
compartimento per l'antenna
compartimento para la antenna

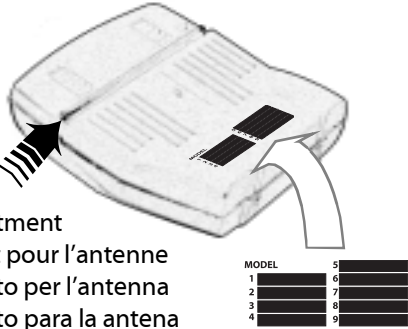

MODEL	5
1	6
2	7
3	8
4	9

V

Hauptplatine
main PCB
platine principale
platina principale
platina principal

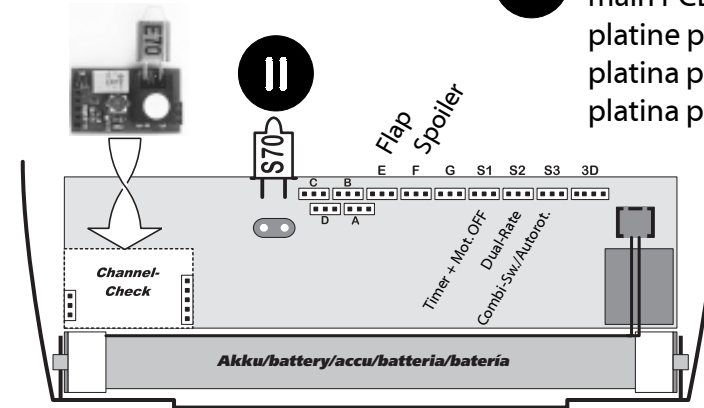

VI

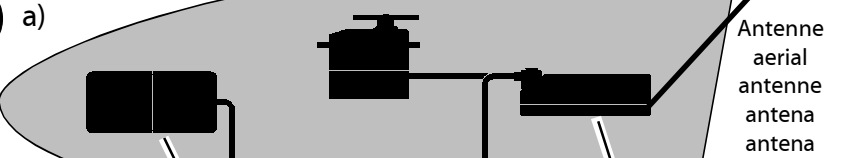

VI



F = Spoiler				F = Gas				Mode	
<input type="checkbox"/>	<input type="checkbox"/>	<input type="checkbox"/>	<input type="checkbox"/>	<input type="checkbox"/>	<input type="checkbox"/>	<input type="checkbox"/>	<input type="checkbox"/>		
H	S	Gas	Q	H	S			5	
Gas	S	H	Q	2	Spoil.	S	H	Q	6
		Gas	S	3	H	Q	Spoil.	S	7
Gas	Q	H	S	4	Spoil.	Q	H	S	8

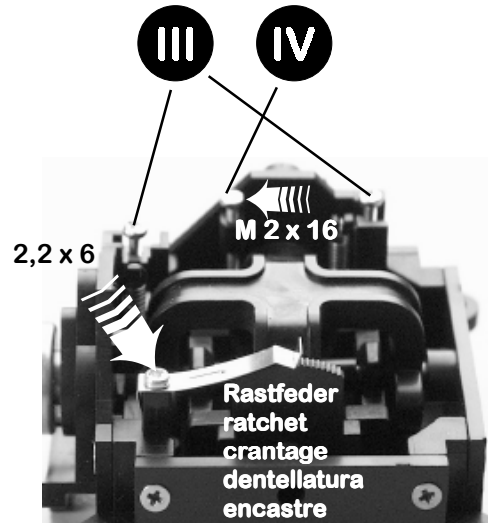
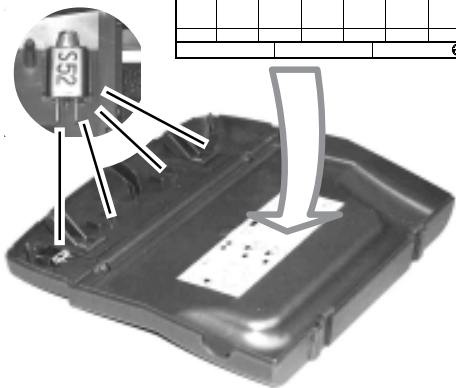

Antrieb
power system
système de propulsion
sistema de propulsión

Empfangsanlage
receiving system
système de réception
sistema de recepción